



## Novojunta® Pro Metal 45



**Novojunta Pro® Metal 45** is a system of profiles made entirely of natural aluminum to be placed in expansion joints up to 45 mm width. Thanks to its ball-and-socket joint system this profile allows multiple movements. With striated face side, high load capacity (heavy loads) and wear resistance, is a perfect profile to be installed in areas with high traffic (people and vehicles). It is delivered pre-assembled with additional metal pieces that keep fixed the position for the installation. Available in natural color.

### Applications

The buildings and constructive elements are under strains caused by thermal variations. The installation of expansion joints helps to minimize the effects that these variations cause in the whole building, preventing a possible structural damage.

The **CTE (Spanish Technical Building Code)**, in the DB-SAE (Document about actions in building), states that in steel or concrete buildings is necessary not to let continuous elements longer than forty meters without installing expansion joints.



**Novojunta® Pro Metal 45** is a solution for structural expansion joints consisting of aluminium sliding pieces. **Novojunta® Pro Metal 45** has a striated visible side which gives it non-slip properties, ideal for floorings. It is suitable for heavy load traffic, being perfect for pedestrian and vehicular traffic and occasional forklifts.

## General Features



Material:	Aluminium 6063-T6
Length:	2,5 ml
Finishes:	Natural

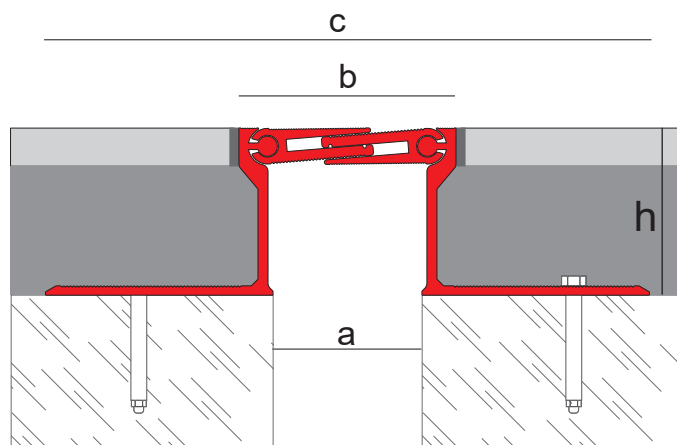

Reference	Height (h):	Joint width (a):	Visible width (b):	Total width(c):	Movement allowed
NJPM45AL22NA25	22 mm	45 mm	65 mm	145 mm	Horiz.: +5/-7 mm Vert.: +/- 7 mm
NJPM45AL50NA25	50 mm			181 mm	

## Perimeter piece

Novojunta® Pro Metal 45 has a special piece available for perimeter installations.

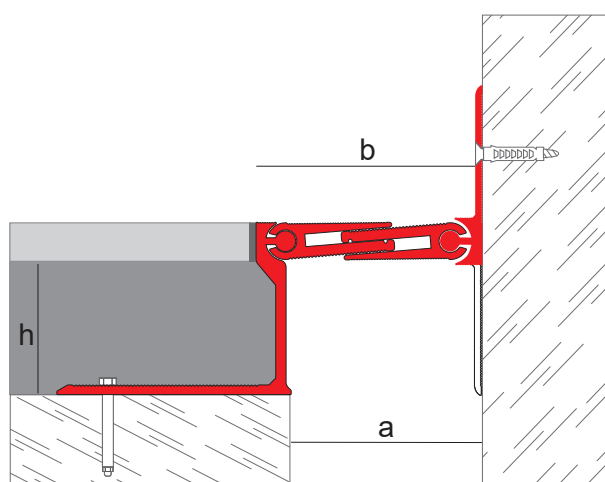

Reference	Height (h):	Joint width (a):	Visible width (b):	Movement allowed
NJPM45AL22PER	22 mm	55 mm	62 mm	Horiz.: +5/-7 mm Vert.: +/- 7 mm
NJPM45AL50PER	50 mm			

### Technical Features

Alloy	6063 - T6
Fire resistance	M0 (UNE 23-727-90)
Load to break $R_m$ (N/mm <sup>2</sup> )	215
Elastic limit (N/mm <sup>2</sup> )	170
Elongation A min (%)	8
Brinell hardness (HB)	75
Conformability	Very good
Corrosion resistance	Very good

### Materials

**Novojunta® Pro Metal 45** is a system of profiles entirely made by aluminum extrusion. The aluminum is a raw material with excellent chemical and physicommechanical properties. It is light, tough, ductile, malleable and highly durable. It has a great resistance to fire and corrosion.

Aluminum is a high valued raw material and it is widely used in several sectors, specially construction. Its transformation processes are multiple, so it can get very different geometries with high performance. This is a recyclable material.

### Load support



**Novojunta® Pro Metal 45** supports heavy loads, which means that allows pedestrian and vehicular traffic. Allows the traffic of vehicles with pneumatic wheels up to 450kN and forklifts or pallet trucks with solid wheel up to 9 kg/mm

### Installation

**Novojunta® Pro Metal 45** is delivered **pre-assembled**, with protective film and metallic omega pieces that keep the profile in its optimal position for the installation.

1. Clean the surfaces to install the Novojunta® Pro Metal 45
2. Place the profile over the expansion joint, without removing the metallic omega pieces supplied.
3. Fix the profile with screws starting by the sides, and then continue with the rest of the fixing screws putting them alternately each 45 cm (6 per meter). Use the screws supplied.
4. Once the profile is correctly positioned and fixed, remove the metallic omega pieces and continue the work until the flooring is finished. You can remove the fixing nuts from the spacers or leave them in position.
- 5.

Novojunta® Pro Metal 45 is a profile designed for joint widths **equal or minor than 45 mm. Never** install the profile in larger widths.

## Cleaning and maintenance

The cleaning must be done periodically with a soft mop. If you use a neutral liquid cleaner, you must rinse the profile with cold water and dry to remove excess moisture. If dirtiness persists, clean the profile with a solution with clean water and detergent or neutral soap 5%, brushing with a mop with no particles that could scratch the finish. Outdoors, rainfall will clean the profile.

Steel wool, abrasive cleaners, souring products as well as strong acids (hydrochloric and perchloric), strong bases (caustic soda or ammonia) or carbonated solutions are not recommended. Citric acid is neither recommended because it dissolves the protective layer of the surface of aluminium. Waxes, petrolatum, lanolin or similar substances are not appropriate. Solvents containing haloalkanes (hydrofluoroether and chlorinated solvents) and curing accelerators containing chlorides should not be used (use special accelerators free of chlorides).

## Technical information

You can find out more information about the technical features of the Emac®'s products by downloading its Technical Files in **[www.emac.es](http://www.emac.es)**.

If you have any query, please contact our Technical Department in **[tecnico@emac.es](mailto:tecnico@emac.es)**.



Outdoors



Indoors



Floorings



Recyclable